



Quick and Easy Application

# Pack Talk

Choose the right wall plug...



- Special application/material
- Type of wall plug
- Suitable material
- Weight
- Drill bit required
- Size and type of screw required



- Application instructions
- Size of Fixing
- Special features

**Choose Blue** For Solid Walls and Floors

**Choose Red** For Hollow Walls and Ceilings

**Choose Green** For all Wall types

## A complete range of plugs suitable for...

### LIGHT TO MIDDLE WEIGHT FITTINGS

- For example:
- Small mirrors & pictures
  - Coat hooks
  - Smoke alarms
  - Dado rails
  - Hanging baskets etc.

### MIDDLE TO HEAVY WEIGHT FITTINGS

- For example:
- Lighting
  - Towel rails
  - Curtain poles
  - Large mirrors & pictures
  - Book shelves
  - Washing lines etc.

### HEAVYWEIGHT FITTINGS

- For example:
- Heavier shelving
  - Cupboards
  - Ceiling fans
  - Bathroom & heating appliances
  - Garage doors etc.



## Setting Tools for Metal Anchors

For best results use a dedicated setting tool when fixing metal anchors into hollow walls.

**Greater control, tighter fit... more secure.**

**Its Quick and Easy...**

Hand lever setting tool, lightweight and easy to use.



**Simple to use...**

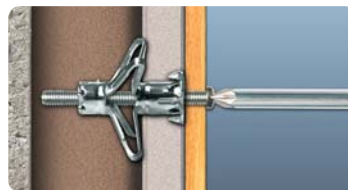
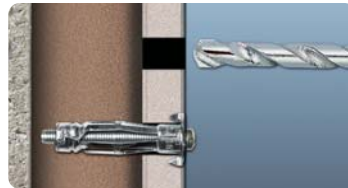

Heavy duty pistol grip setting tool.

1. Drill the hole to the correct diameter for the Fixing (see pack).
2. Insert the Fixing.
3. Pull until you feel resistance, the Fixing opens up and grips to the wall.
4. Remove the screw from the Fixing. Put the fitting to the wall and screw tight using a hand screwdriver.

**...gives effortless results!**

[www.blackanddecker.eu](http://www.blackanddecker.eu)

# Guide to wall plugs and fixings

**Blue for Solid Walls**

**Red for Hollow Walls & Ceilings**

**Green for all Wall Types**





Choose Blue for Solid Walls and Floors



Choose Green for all Wall Types



Choose Red for Hollow Walls and Ceilings

### Heavy Duty Nylon Plugs



**HI-TECH**  
High Performance Fixings.

Extra Strong = **NYLON**



With unique No-Spin design for greater control.



Extra Strong = **NYLON**



**Strong Plastic Plugs**  
For extra value.

### Thermal Block Fixing

Cuts into material for extra grip.

### Specialist plugs and bolts...

For bathroom fittings and heating appliances... window frames, gates and heavyweight fittings both indoor and out.

#### Heavy Duty Bolts



Hinge bolt ideal for gates.

Through bolt ideal for heavy duty tasks.



Bolt shield - also available with hook and eye.

#### Window Frame Fixing

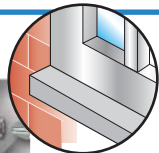

For fixing window frames into solid walls.

#### Sanitary Fixings For washbasins and toilets.



### Heavy Duty Metal Anchors

Ideal for hollow brick in cavity walls also suitable for solid walls.

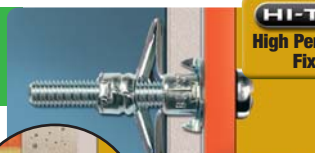

**HI-TECH**  
High Performance Fixings.

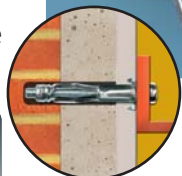

Use a Setting Tool...  
...for quick and easy application



### Can't decide? - try these durable nylon plugs

Fits all wall types.



Nylon plugs available with and without screws, hooks and eyes.

Extra Strong = **NYLON**



Nylon plugs with or without screws.

#### Hammer in Fixings

Drill a hole and hammer in...  
ideal for door frames, skirting boards etc.

Extra Strong = **NYLON**

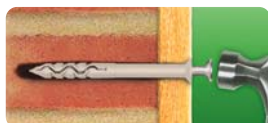

### Expanding Metal Plugs

Ideal for plasterboard.  
Gives extra strength.



Use a Setting Tool ...  
...for quick and easy application



Inventors of the Metallic Cavity Anchor in 1971



Metal plugs with hooks and eyes.

### No drilling required - quick and easy, strong and secure

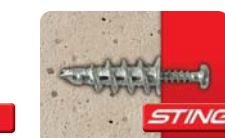
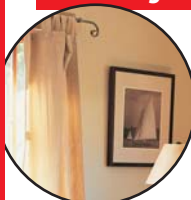

Ideal for plasterboard.

For cellular walls.

### Specialist Jobs

For ceilings,  
hollow doors and  
sanitary fittings.



Expanding anchor for bathroom fittings.



Spring toggle, for fixing into cavity ceilings.

Swing toggle, for fixing into cavity ceilings.

Butterfly fixing, ideal for hollow doors.